

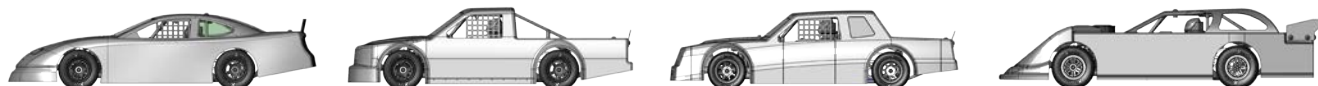

RACER KIT MANUAL

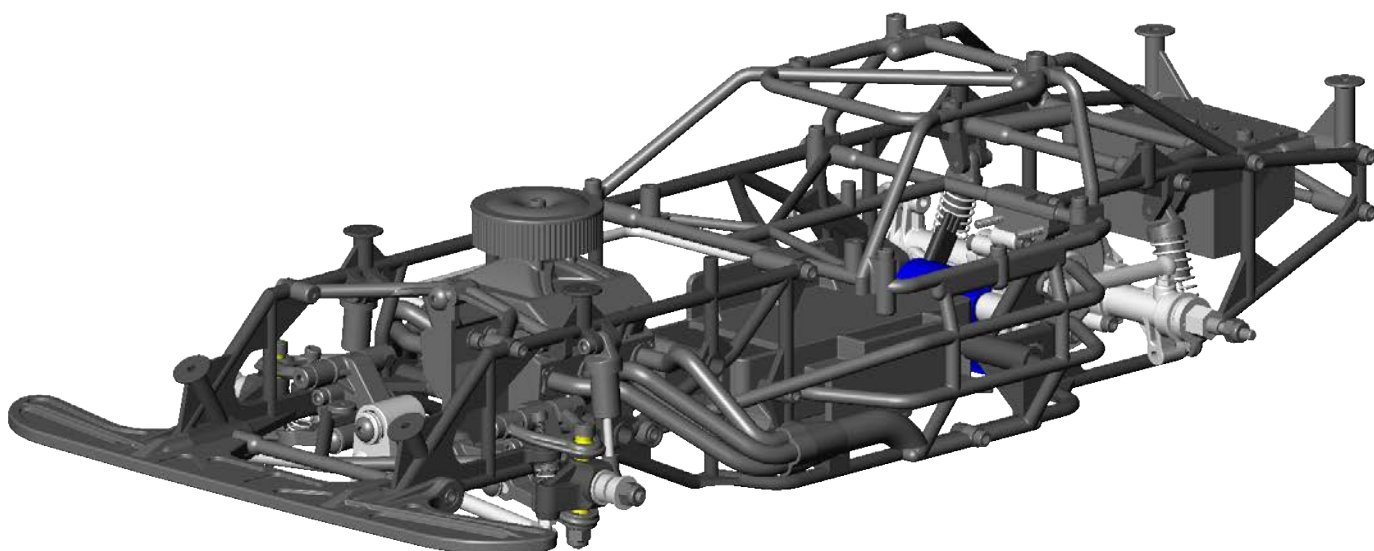

1RC1089

WWW.1RC-RACING.COM



Before operating this model, please read this entire /Instruction Manual and all printed materials related to this model. Read and follow all warnings and precautions. Failure to follow all warnings and precautions while operating this model could result in personal and/or property damage.

SAFETY PRECAUTIONS

- **WARNING—CHOKING HAZARD—SMALL PARTS—NOT FOR CHILDREN UNDER 5 YEARS OLD.**
- **THIS RADIO CONTROLLED RACING CAR IS NOT A TOY!**
- **THIS HIGH-PERFORMANCE R/C MODEL IS RECOMMENDED FOR AGES 14 AND OLDER.**
- **THIS IS ONLY FOR YOUR REFERENCE BEFORE YOU OPERATE THE MODEL CAR.**
- **ASSEMBLE THIS KIT ONLY IN PLACES OUT OF CHILDREN'S REACH!**
- **TAKE ENOUGH SAFETY PRECAUTIONS PRIOR TO OPERATING THIS MODEL. YOU ARE RESPONSIBLE FOR THIS MODELS ASSEMBLY AND SAFE OPERATION!**

Safety Precautions and Warnings

Please read all warnings and precautions in this Instruction Manual along with any other documentation provided for this model. Failure to operate your model in a responsible and safe manor may result in personal property damage and/or personal injury. As the user of this model, you are solely responsible for operating the model in a safe manor. 1 RC Racing, LLC shall not be liable for any loss or damages, direct, indirect, special, incidental, or consequential that occurs during the use, misuse, or abuse of this vehicle or any product required to operate it.

- **WARNING—CHOKING HAZARD—SMALL PARTS—NOT FOR CHILDREN UNDER 5 YEARS OLD.**
- This radio controlled racing car is not a toy!
- This high-performance R/C model is recommended for ages 14 and older.
- This is only for your reference before you operate the model car.
- Do not change the equipment of the brushless ESC, motor and battery casually, we will not take any charge of the damages or injuries caused by your changes!
- Assemble the kit only in places out of reach of children's reach!
- Take enough safety precautions prior to operating this model. You are responsible for this models assembly and safe operation.
- This model contains many small parts that could cause a choking hazard, keep all part away from children.
- This model is intended for smooth track use only, this model is not intended for off-road use. Track surface should be smooth with minimal bumps.
- Never operate your model with low transmitter and/or model batteries.
- This model is controlled by a radio signal that could be subject to interference from many sources outside your control. This interference may result in the loss of control so ensure you as the operator of this model always keep some distance in all directions around your model as a safety margin to avoid personal and/or property damage to you and others in the area.
- Never operate your model in a public street or congested area and always keep away from cars, traffic and crowds of people.
- Never operate your model at night or anytime line of sight may be obstructed or impaired in any way.
- This model is small so ensure you run your model in a non-crowded area so nobody trips on model.
- This model is small and could be a trip hazard, ensure you only run the car in a safe area.
- This model is not waterproof, ensure vehicle is not run in wet conditions.
- Always turn on your transmitter first, then model.
- Do not put fingers on or near any moving part, this may result in serious injury or damage model.
- After running model, NEVER touch items like motor, battery, or electronic speed control as these items may be hot and result in serious injury as they may generate high temperatures during operation.
- When you are done using model, turn off model first, then transmitter.
- Never store model with battery installed or plugged in, always ensure battery is unplugged and removed before storage. Store battery in safe place.
- Never leave battery on charger for more than 1 hour and always unplug charger from wall when not in use. Never charge a battery that is hot or damaged.
- Some details and images in this manual might not exactly reflect the items you find in you model box.

KIT DETAILS

IMPORTANT ASSEMBLY NOTE

The hardware on this kit are extremely small and the threads are also small, DO NOT OVERTIGHTEN ANY HARDWARE WHEN INSTALLING, 1RC RACING WILL NOT REPLACE ANY ITEMS THAT YOU, AS THE USER, STRIP OUT FROM OVERTIGHTENING.

This assembly manual will guide you through the process to assemble this Racer Kit. With the Racer Kit you can build your car in one of four configurations that includes the Asphalt Late Model, Asphalt Truck, Dirt Street Stock, and Dirt Late Model. This kit comes with everything you need to build a complete chassis. All electronics, mounted tires, and body must be supplied by the user. Pay close attention to each bag to ensure you are building your desired configuration. Take some time to read over the manual before you start the assembly steps to get familiar with the assembly process, this will be very helpful as you start the assembly. We recommend you follow the steps we have detailed in this manual and do not jump from step to step. .

Each section is by a Bag # and you will find these bags labeled in your kit. We recommend you only open the bag noted for each step so you do not get any of the parts confused. The screws and hardware for these cars are small and sometimes can get lost during the opening of the bags. If you find you are missing some hardware like screws for a particular step, we have included a spare hardware bag called "Spare Parts" in the kit where you can find anything that might be missing.

Below you will find a hardware chart that details the hardware for this kit. Also noted below are the tools we recommend to build this kit. We included a Long Handled 1.5mm Hex Driver (1RC8810) and our standard 3mm/4mm Nut Driver to ensure you have a positive build experience. Use the included Pit Tray (1RC8822) to organize your parts as you build each bag.

Items Required to Complete this Kit

- Electronic Speed Controller - 1RC7014
- Battery - 1RC7007
- Servo - 1RC7020 or 1RC7017 (if using 1RC7017 you will need 1RC3025 Servo Arm)
- Transmitter and Receiver - 1RC7012
- Motor - 1RC7003 - 8700Kv or 1RC7011 -10000Kv
- Mounted Tires and Body

Recommended Tools

1RC Racing tools are available at your 1RC Racing Authorized Dealer or online at www.1RC-RACING.com

- 1RC8801 - 1.5mm Hex Driver, Mini Handle, Black
- 1RC8802 - 3.0mm Hex Socket Driver, Mini Handle, Black
- 1RC8803 - 4.0mm Hex Socket Driver, Mini Handle, Black
- 1RC8830 - Diagonal Flush Cut Pliers
- Hobby Knife
- Small Needle Nose Pliers
- Dial or Digital Calipers

Hardware

 1RC8000 - M1.6 x 6mm SHCS

 1RC8000 - M1.6 x 10mm SHCS

 1RC3021 - M2.0 x 20mm SHCS

 1RC3021 - M2.0 x 4mm Truss Head



 1RC8000 - M2.0 x 6mm Truss Head

 1RC8000 - M2.0 x 10mm Truss Head

 1RC8000 - M1.6 x 12mm Truss Head

 1RC8001 - M2.0 x 3mm Short Ball Stud

 1RC8001 - M2.0 x 4mm Long Ball Stud

  1RC8000 - M2.0 Nylock Nut

 | 1RC3021 - M2 Washer

BAG 1 - STEP 1 - BATTERY TRAY ASSEMBLY

REMINDER
Do not overtighten
screws.

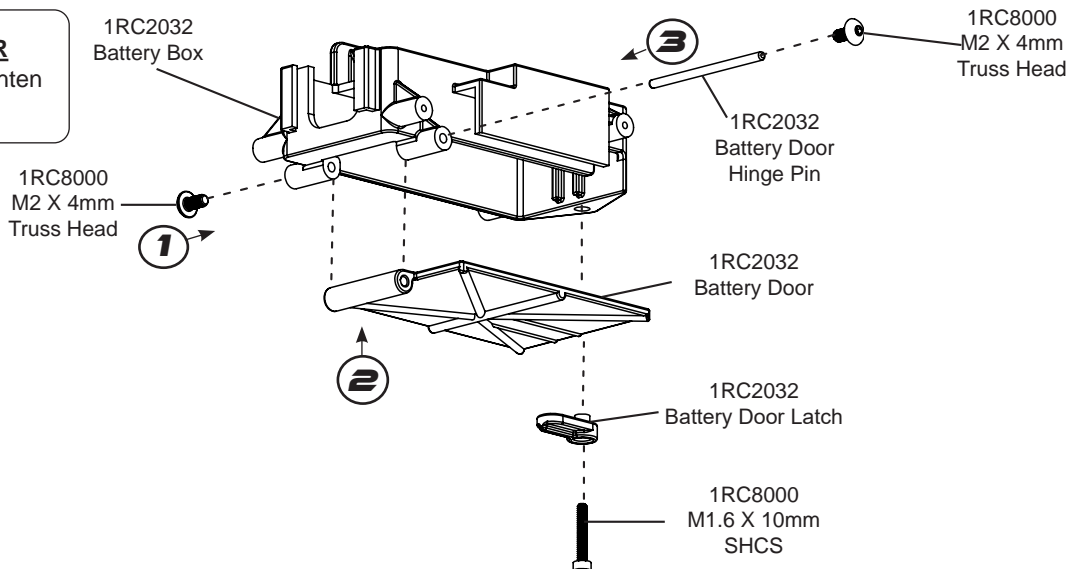

BAG 1 - STEP 2 - ESC AND RECEIVER INSTALLATION

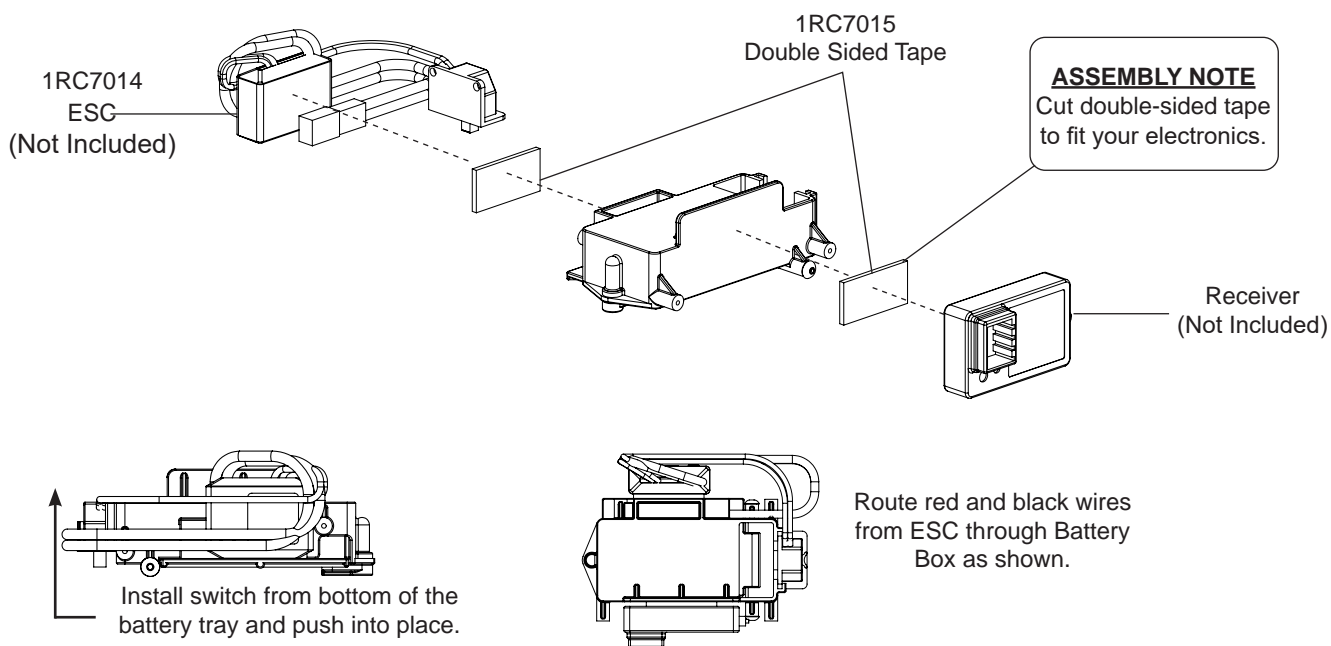

BAG 1 - FINAL ASSEMBLY

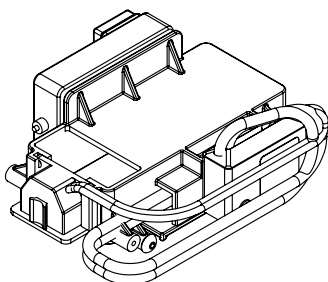

BAG 2 - STEP 1 - SHOCK SHAFT ASSEMBLY

ASSEMBLY NOTES

- Ensure O-Ring is fully seated on the Shock Shaft O-Ring groove.
- Due to the small O-Rings we have included four extra O-Rings
- We recommend adding O-Ring lube or oil of your choice to the shock shaft O-Ring before installing into the shock body

1RC5011
Shock Shaft
O-Ring

1RC5010
Shock Shaft

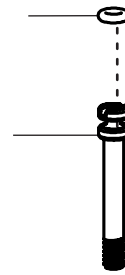

Apply oil or lube
around these
surfaces.



BAG 2 - STEP 2 - SHOCK ASSEMBLY

ASSEMBLY NOTES

- Ensure when installing the Shock Shaft into the Shock Body, the O-Ring does not get pinched or pulls off the shock shaft. Remove any burrs on top of the shock body that may cause O-Ring interference.
- DO NOT overtighten the Shock Ball Cup as it may damage the ball cup.
- Using dial calipers, measure the bottom of the shock body to the top of the shock ball cup and ensure the distance is equal on all four shocks. 1RC recommends 7.3mm.
- Build 4X

1RC5004
Shock Cap

1RC5004
Shock Body

1RC5004
Shock Ball Cup

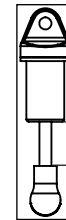
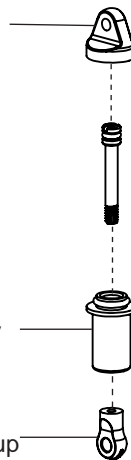

7.3mm

Measure
between these
two surfaces.

BAG 2 - STEP 3 - SHOCK SPRING ASSEMBLY

ASSEMBLY NOTES

- The two Spring Adjusters are shown for reference only. Install the spring clips as needed for running conditions.
- Build 2X shocks with spring and spring cup (Rear Shocks).
- Build 2X shocks without spring and spring cup (Front Shocks).

1RC5004
Spring Adjuster
1mm

1RC5004
Spring Adjuster
2mm

1RC5001
Medium Spring

1RC5004
Spring Cup

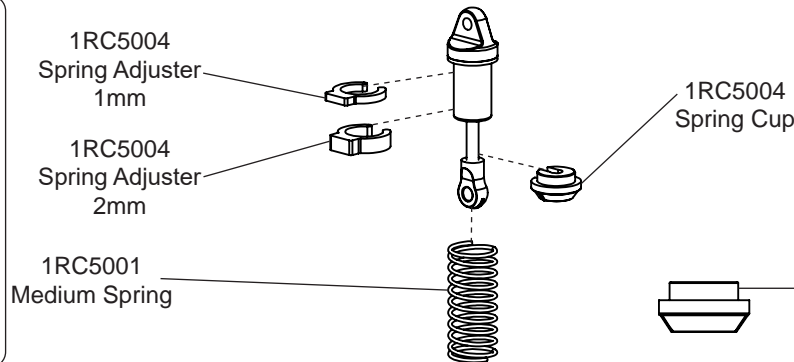

Ensure the spring cup
is installed correctly
onto the shock shaft.
The spring will rest on
the top of the spring
cup.

BAG 2 - FINAL ASSEMBLY

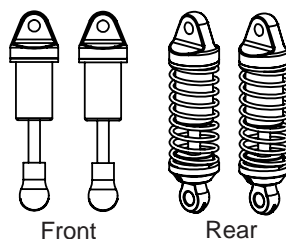

Front

Rear

BAG 3 - STEP 1 - SIDE AXLE ASSEMBLY

REMINDER

Do not overtighten screws.

ASSEMBLY NOTE

Ensure to use 3mm **Short** Ball Stud

1RC8503
3mm x 6mm x 2.5mm
Flanged Bearing

1RC8503
Bearing Shim

1RC8001
Ball Stud
3mm Short

1RC3000
LH Side Axle
Tube

1RC3000
RH Side Axle
Tube

1RC8001
Ball Stud
4mm Long

1RC8503
3mm x 6mm x 2.5mm
Flanged Bearing

ASSEMBLY NOTE

Ensure both Bearings are completely seated in the Axle Tubes. If the Bearings are not fully seated, remove the Bearing and check area for any burrs. If burrs are found, carefully remove with a hobby knife.

1RC8001
Ball Stud
4mm Long

BAG 3 - STEP 2 - RIGHT AXLE ASSEMBLY

ASSEMBLY NOTE

When installing the Screws to secure Axle Tube to RH Gear Case, ensure both screws are tightened the same amount so the Axle Tube is fully seated on the RH Gear Case.

1RC8000
M1.6 x 6mm
SHCS

1RC3000
RH Gear Case

1RC8001
Ball Stud
3mm Short

ASSEMBLY NOTE

Ensure to use 3mm **Short** Ball Stud

BAG 3 - STEP 3 - TRANSMISSION ASSEMBLY

1RC8000
M1.6 x 6mm
SHCS

ASSEMBLY NOTE

Ensure bearing is fully seated in gear case.

1RC4001
Rear Axle Shaft/Gear

1RC3000
Center Gear Case

1RC8000
M1.6 x 6mm
SHCS

BAG 3 - STEP 4 - TRANSMISSION ASSEMBLY

ASSEMBLY NOTE

Ensure bearing is fully seated in gear case.

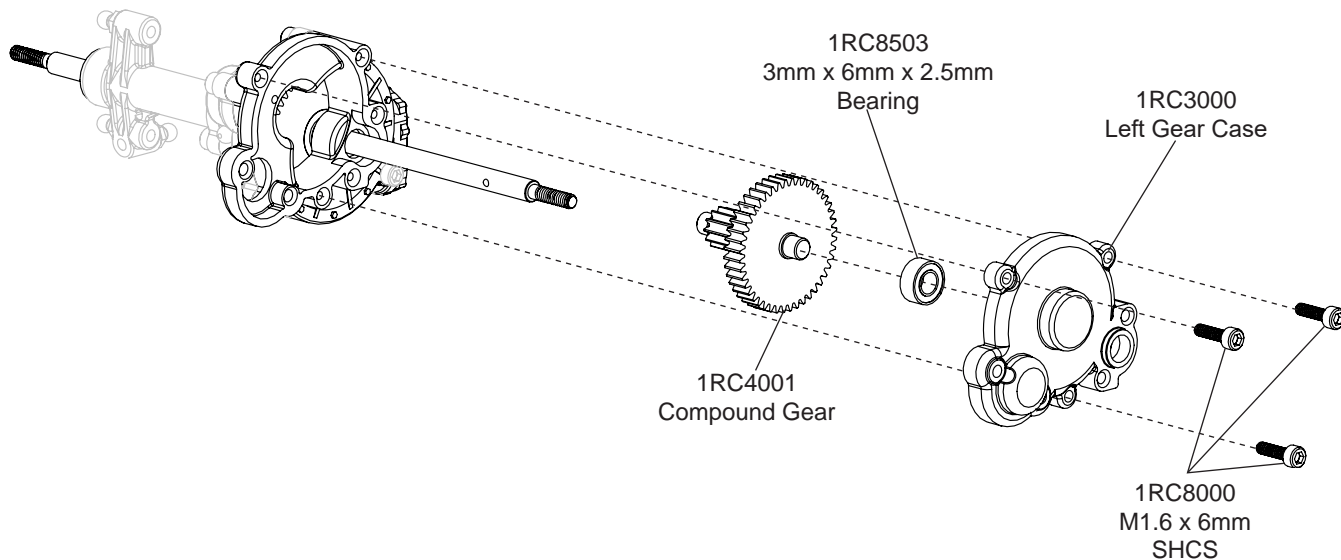

BAG 3 - STEP 5 - TRANSMISSION ASSEMBLY

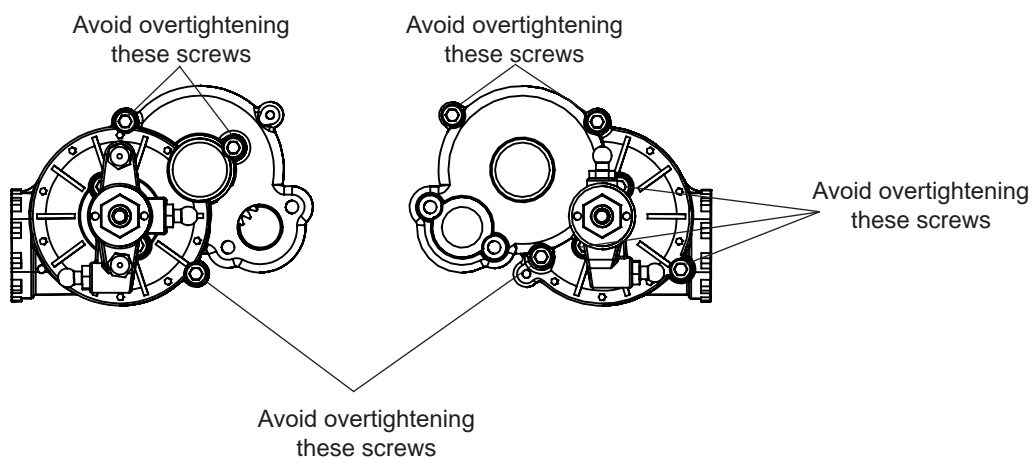
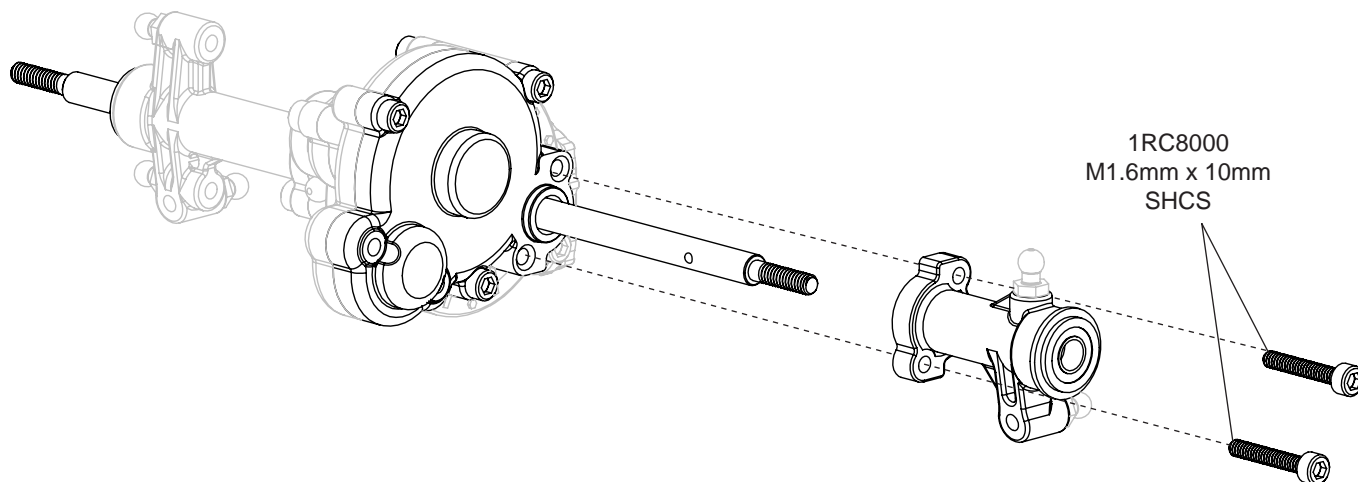

BAG 3 - STEP 6 - MOTOR INSTALLATION

ASSEMBLY NOTES

- Ensure the 1RC Racing Motor installed has a 10T pinion. Use only 1RC7003 or 1RC7011 or the gears will strip.
- When installing the Motor, **do not overtighten** the Motor Screws. A snug fitment is fine.
- **When handling the motor, ensure the motor wires never bend, as bending the wires can cause the motor to short out.**
- Note figure 3.6 below for motor orientation when installing. It is recommended to install the motor in this orientation only.

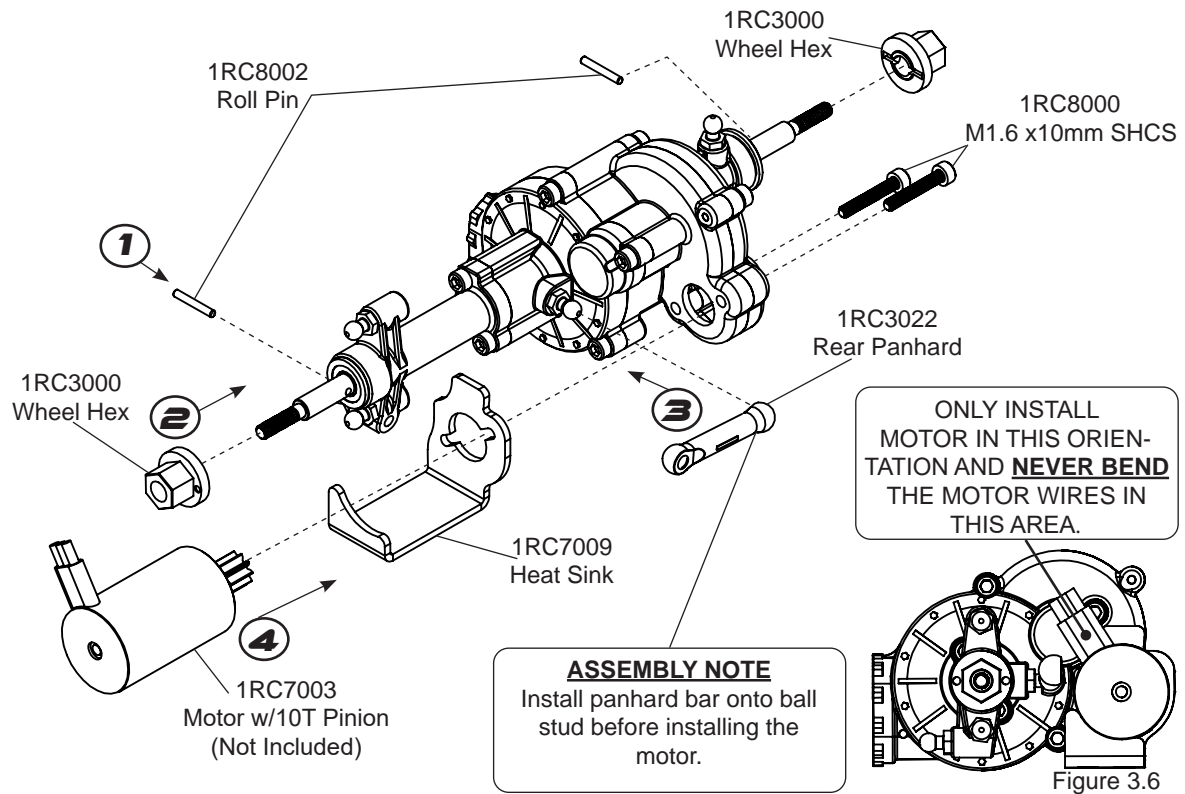

BAG 3 - FINAL ASSEMBLY

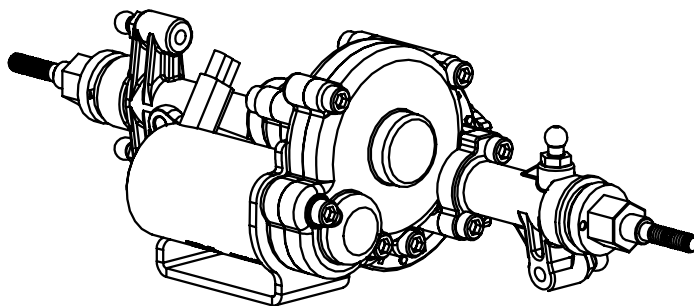

BAG 4 - BAG 1 - STEP 1 - ENGINE ASSEMBLY

DIRT LATE MODEL

REMINDER

Do not overtighten screws.

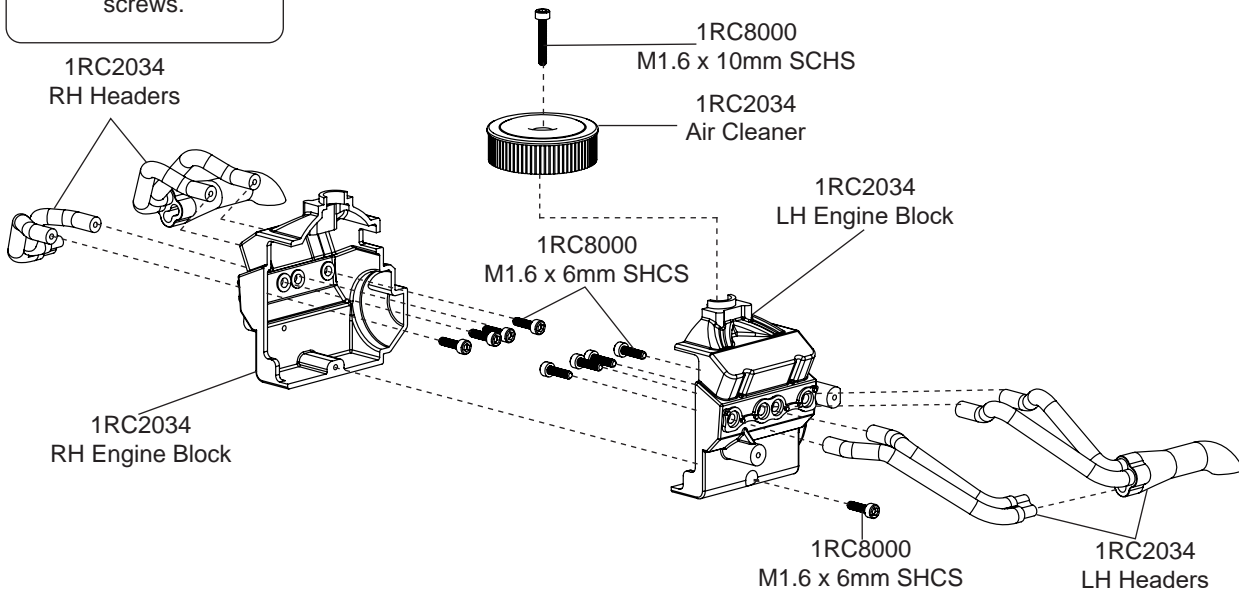

ASPHALT LATE MODEL, TRUCK , DIRT STREET STOCK

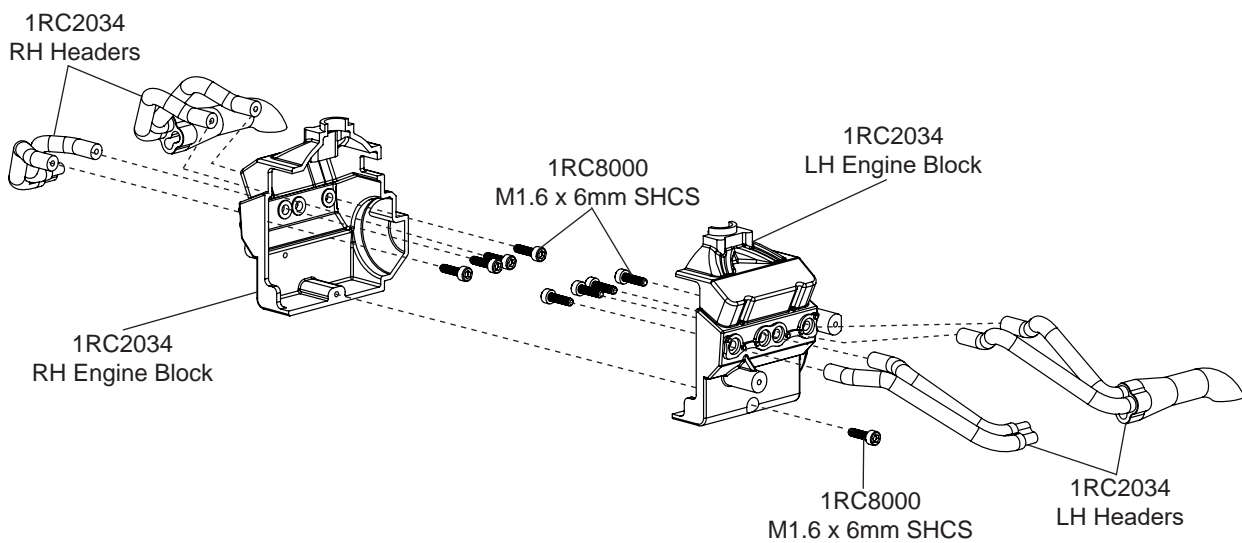

BAG 4 - STEP 3 - CHASSIS ASSEMBLY

ASSEMBLY NOTES

- Make spring platform flush with the bottom of the screw.
- Use 1mm of spacing for initial spring preload.

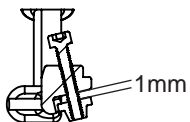

1RC8000
M1.6 x 10mm SHCS

ASSEMBLY NOTE

Use 1RC2038 Frame Rails when building Dirt Street Stock.

1RC3020
Spring Platform

1RC3020
Spring Platform

1RC2032
LH Chassis Side

ASSEMBLY NOTE

Ensure to use
3mm **Short** Ball
Stud

1RC8001
Ball Stud
3mm Short

1RC8001
Ball Stud - 4mm Long

1RC2058
Side Nerf Bar

BAG 4 - STEP 4 - CHASSIS ASSEMBLY

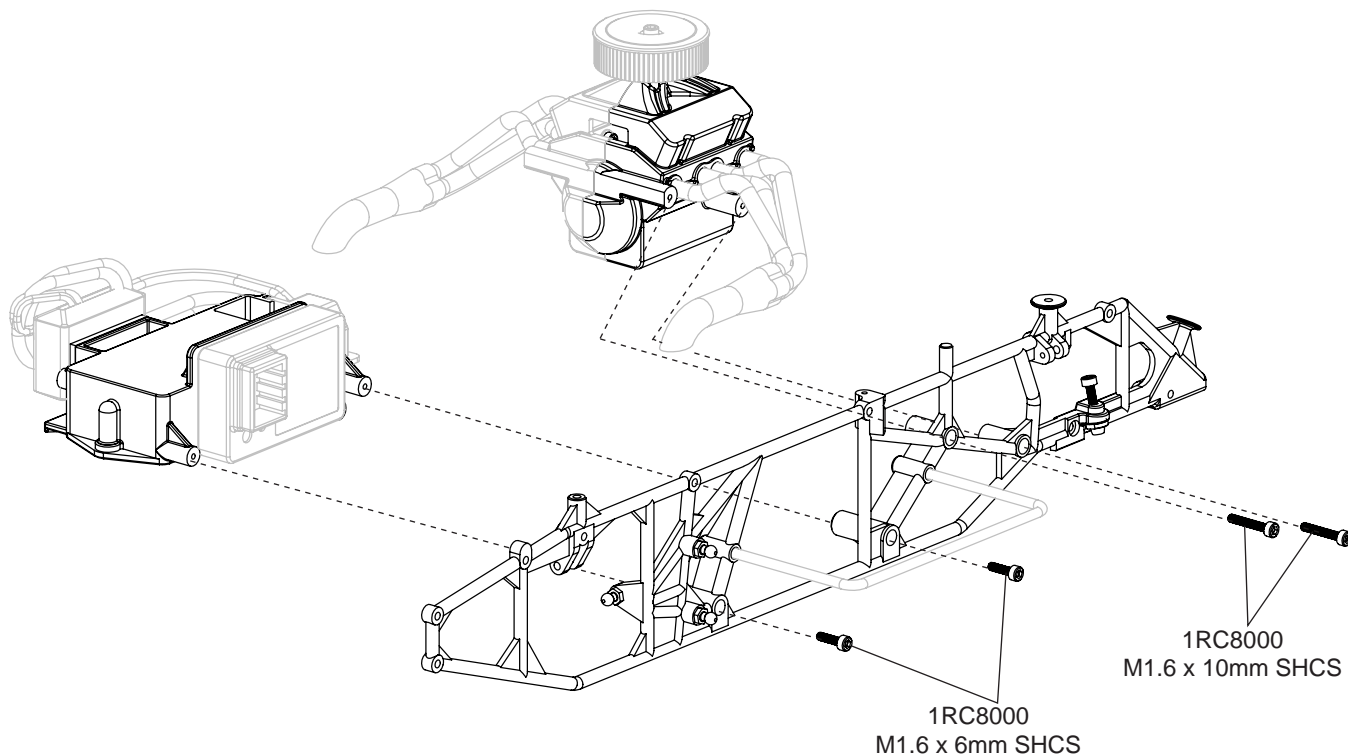

BAG 4 - STEP 5 - SERVO ASSEMBLY

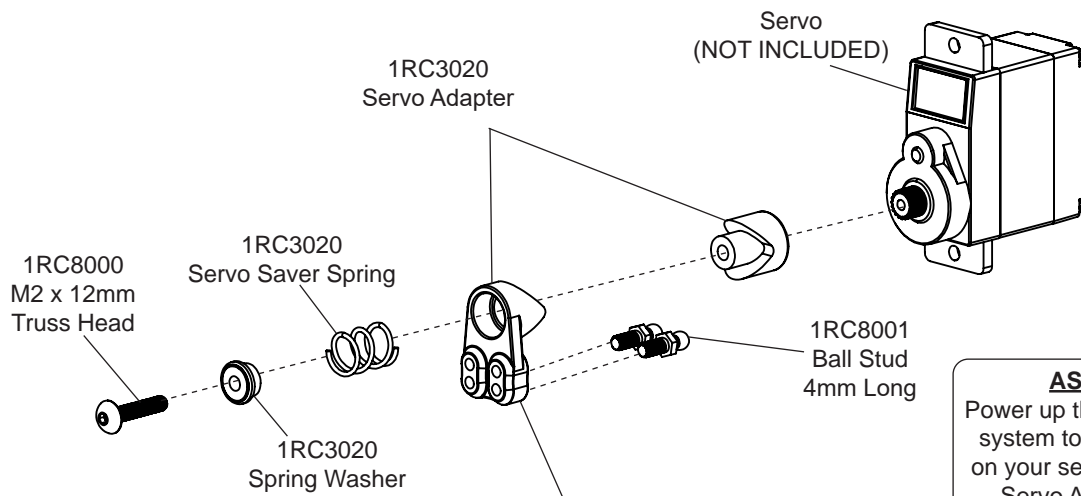

Assembly Note

Install ball studs into the lower holes.

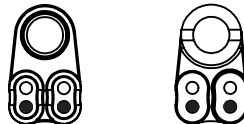

ASSEMBLY NOTE

Power up the Servo with your radio system to set the center position on your servo before installing the Servo Adapter on the Servo.



BAG 4 - STEP 6 - RIGHT SIDE CHASSIS ASSEMBLY

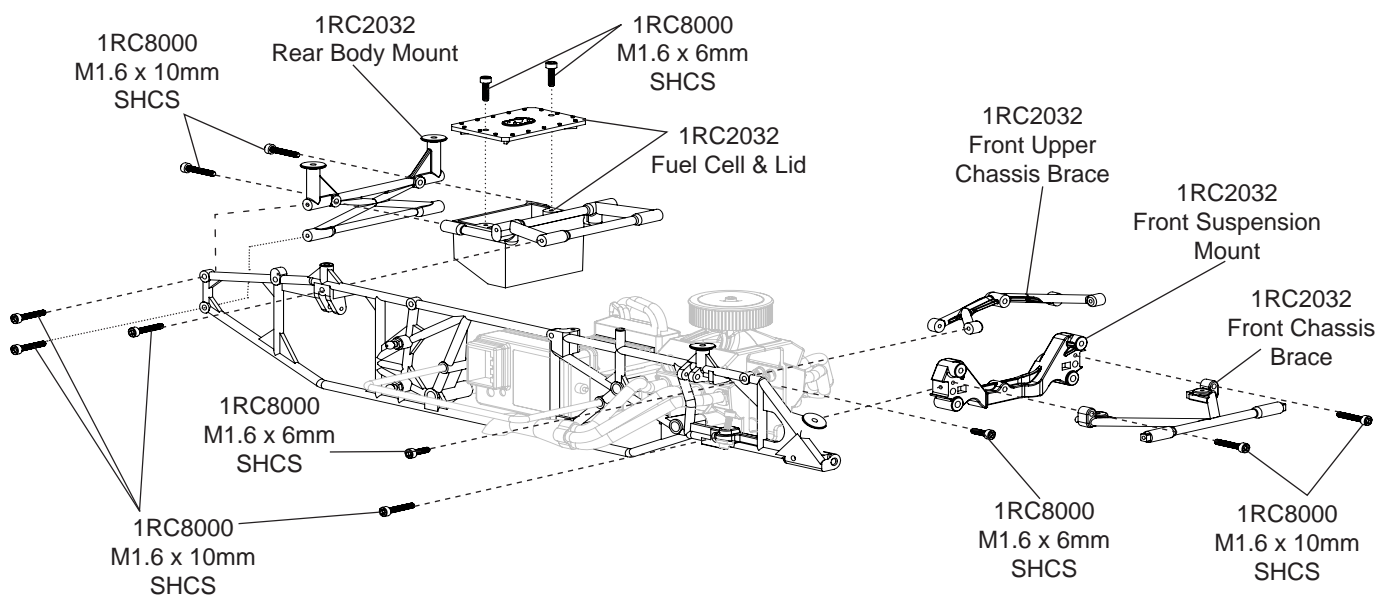

BAG 4 - STEP 7 - LEFT SIDE CHASSIS ASSEMBLY

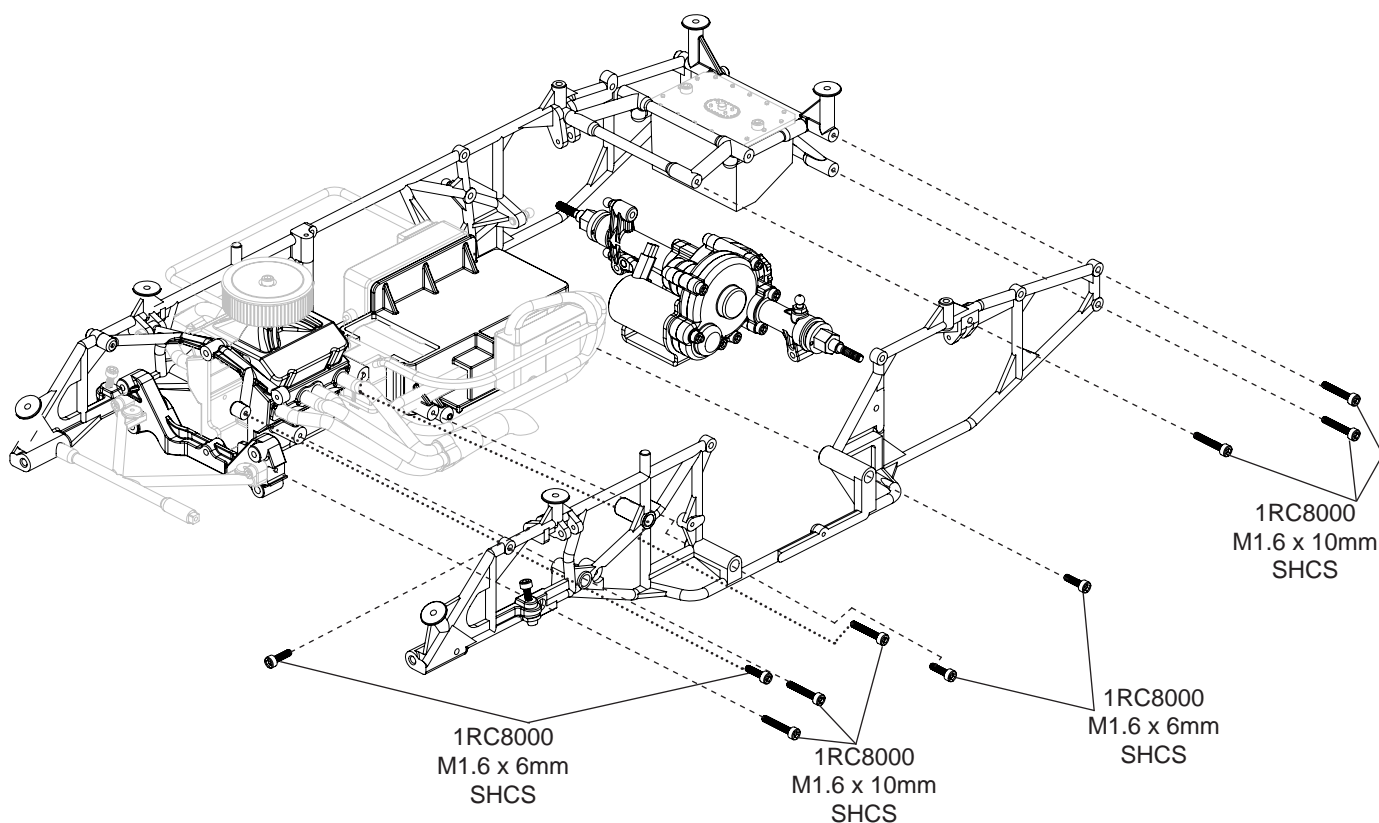

BAG 4 - STEP 7 - CHASSIS ASSEMBLY - SERVO INSTALL

ASSEMBLY NOTES

- Plug Extension Wire into Servo Wire and feed Extension Wire through back side of Engine Block and route to the receiver as needed.
- Push excess wire from Extension Wire and Servo Wire into engine block.

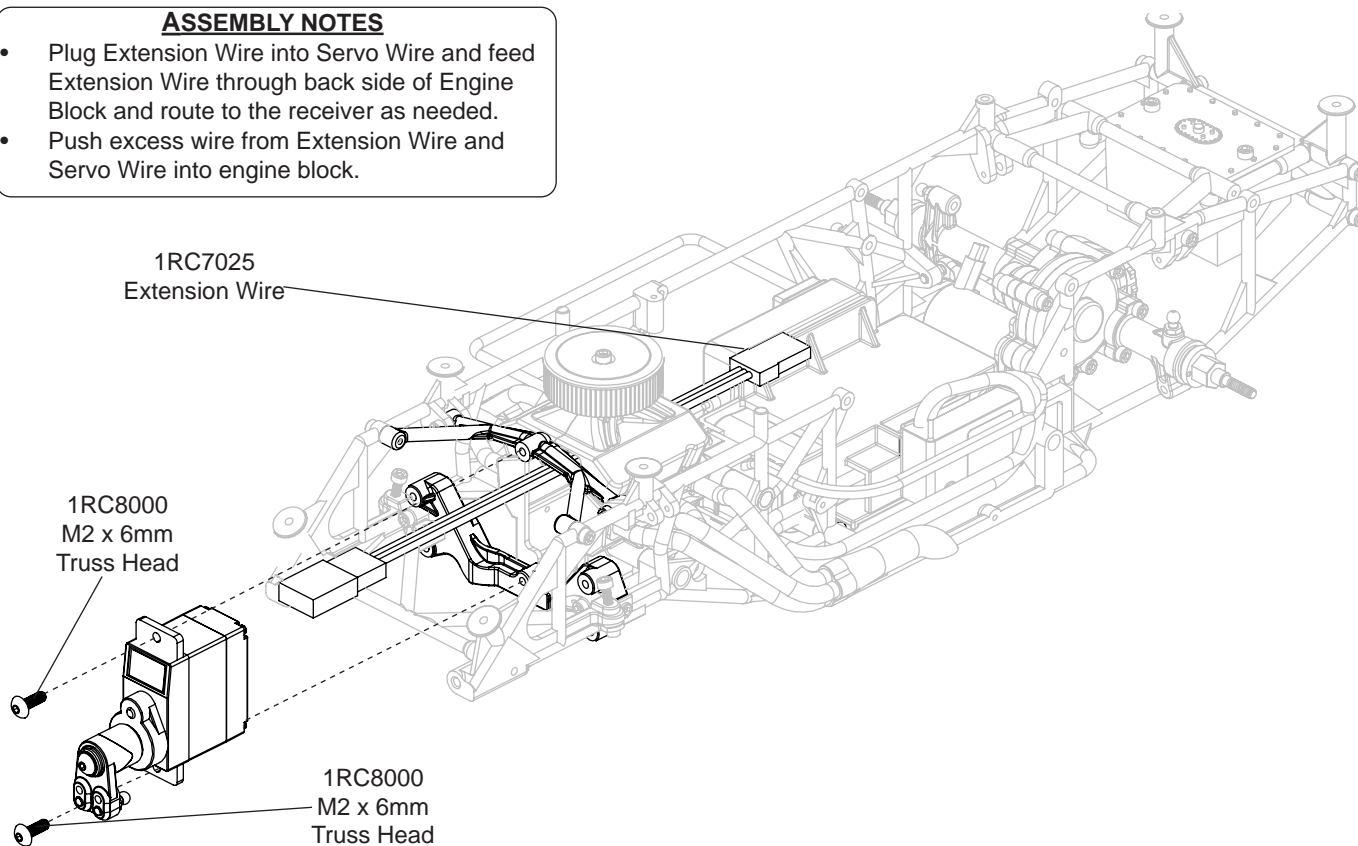

BAG 4 - STEP 8 - REAR SHOCK & RADIUS ROD INSTALL

ASSEMBLY NOTE

Do not overtighten shock screws. Ensure shock moves freely before connecting it to the ball stud.

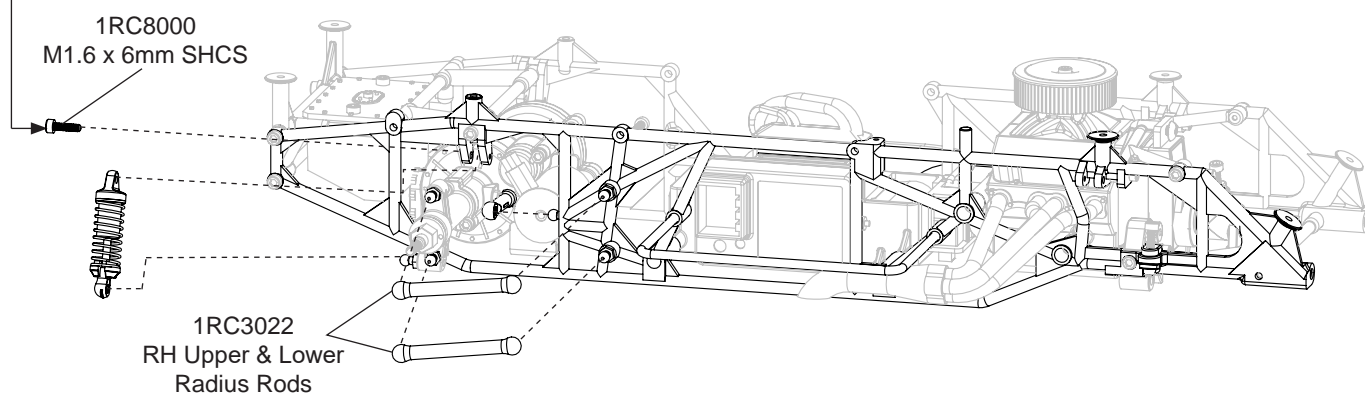

BAG 4 - STEP 9 - CAGE ASSEMBLY

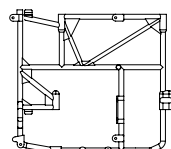

1RC2073/2077
Upper Cage Mount

Asphalt Truck
(1RC2073)

Dirt Street Stock
(1RC2077)

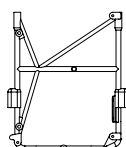

1RC2032
Upper Cage Mount

Dirt Late Model
Asphalt Late Model

ASSEMBLY NOTE

Only install if you are
building the Dirt Late
Model

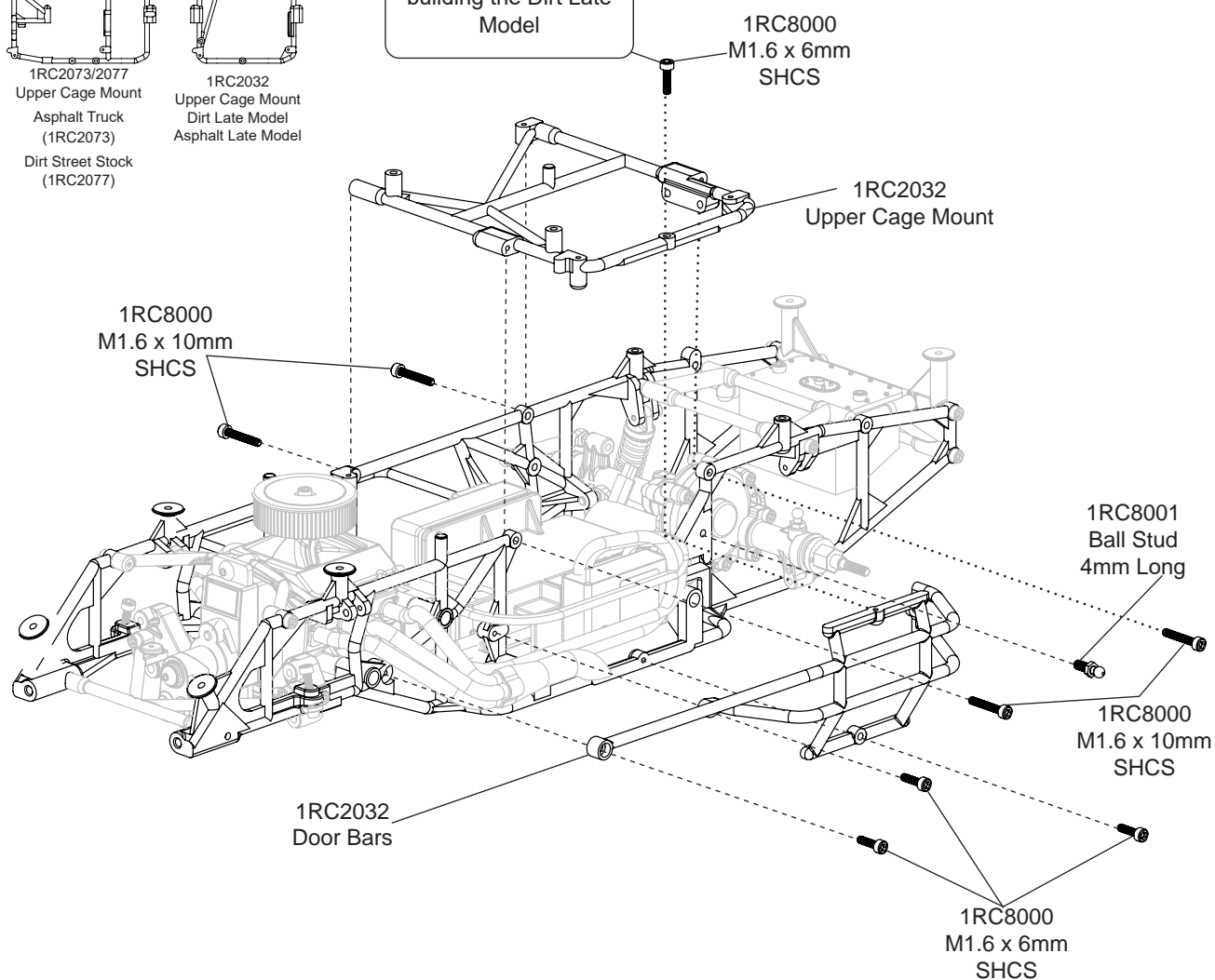

BAG 4 - STEP 10 - REAR SHOCK & RADIUS ROD INSTALL

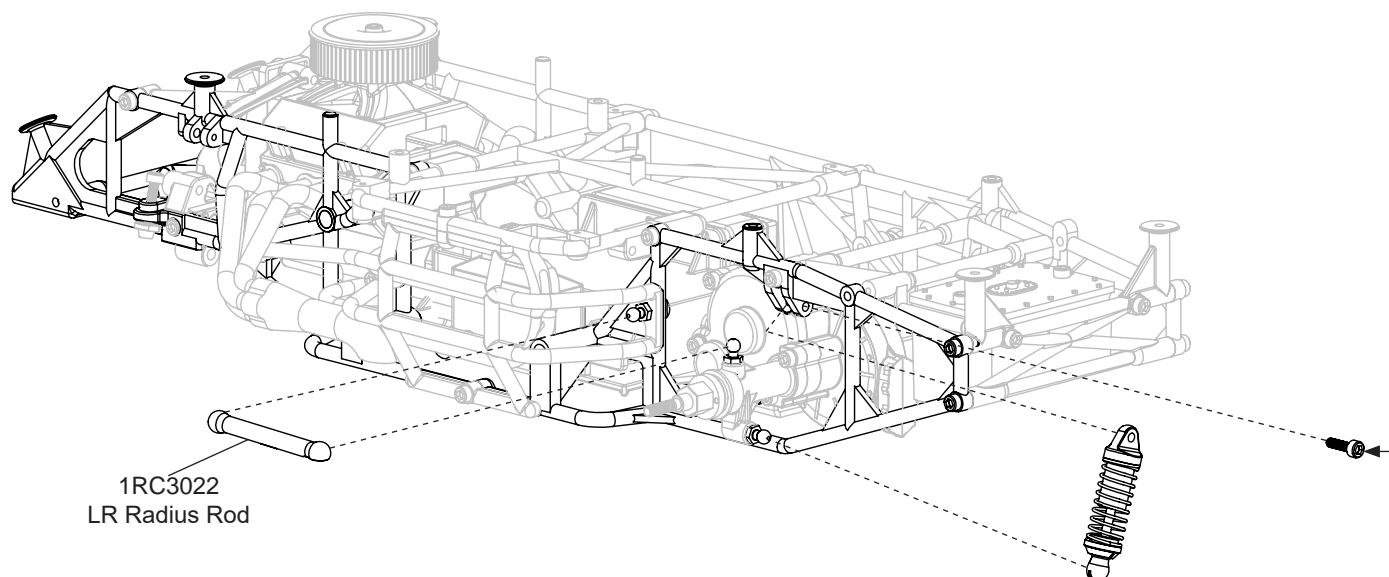

ASSEMBLY NOTE

Do not overtighten shock screws. Ensure shock moves freely before connecting it to the ball stud.

BAG 4 - STEP 11 - DRIVER ASSEMBLY

ASSEMBLY NOTE

First connect Nut Plate to the Helmet. Then connect the Headrest to the Driver Figure and into Nut Plate.

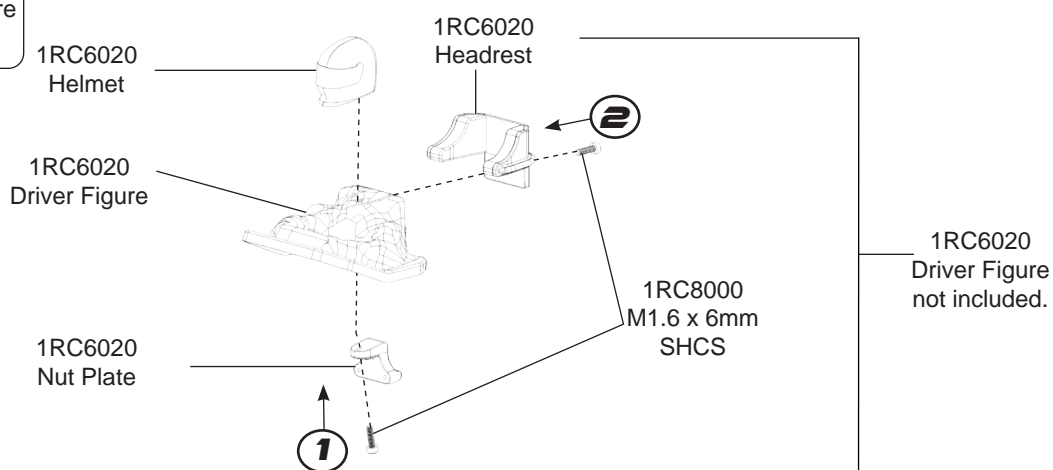

BAG 4 - STEP 12 - CAGE ASSEMBLY

ASSEMBLY NOTE

First attach Rear Cage Downbar to Rear Cage Hoop. Then attach Front Cage Downbars to Rear Cage Hoop.

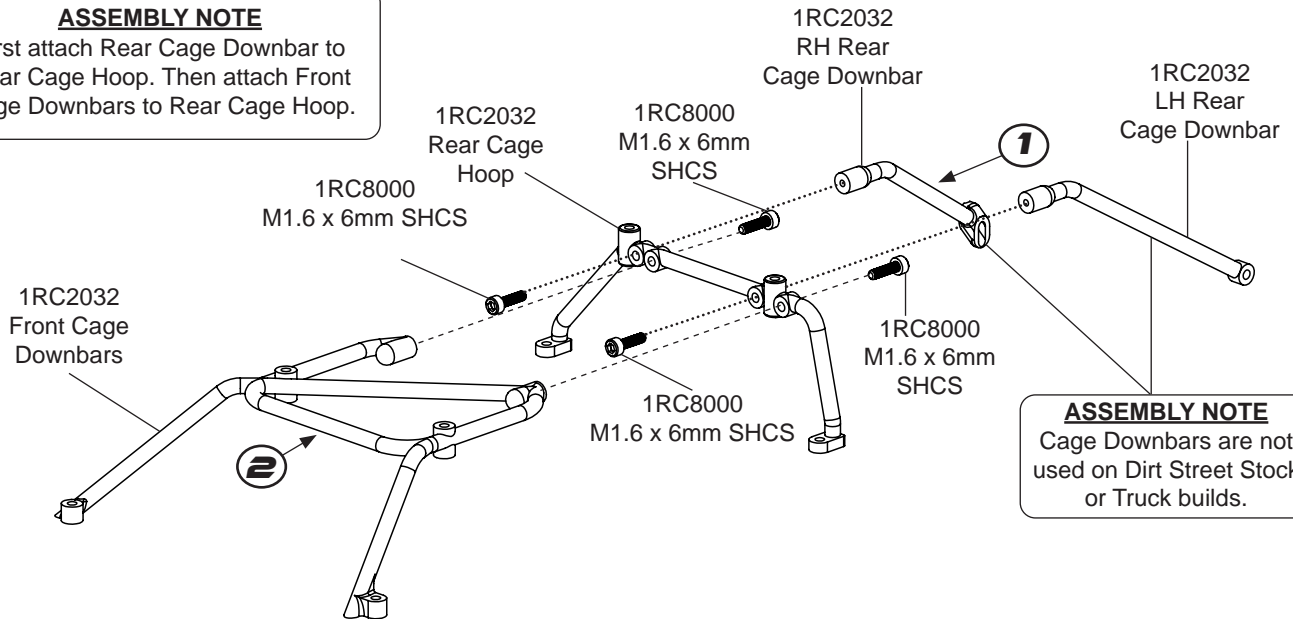

ASSEMBLY NOTE

Cage Downbars are not used on Dirt Street Stock or Truck builds.

BAG 4 - STEP 12 - CAGE ASSEMBLY - ASPHALT LATE MODEL

ASSEMBLY NOTE

First attach Rear Cage Downbar to Rear Cage Hoop. Then attach Front Cage Downbars to Rear Cage Hoop.

ASSEMBLY NOTE

1RC2056 Body mount only required for Asphalt Late Model.

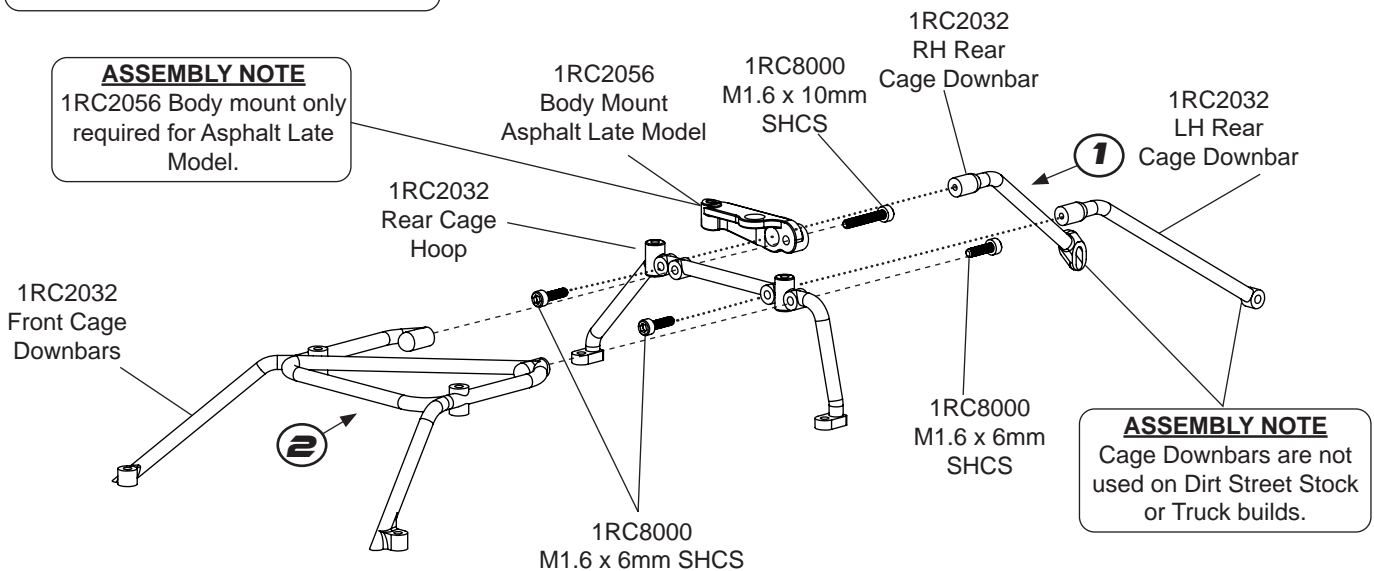

ASSEMBLY NOTE

Cage Downbars are not used on Dirt Street Stock or Truck builds.

BAG 4 - STEP 13 - CAGE BAR & DRIVER PANEL ASSEMBLY

1RC6059
Asphalt Late Model
Inner Panel
(Not Included)

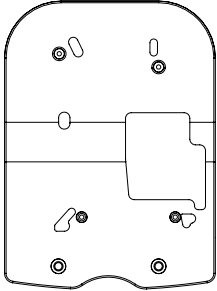

1RC6064
Dirt Late Model
Inner Panel
(Not Included)

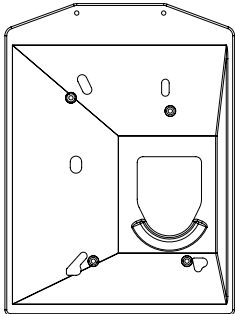

1RC6070
Asphalt Truck
Inner Panel
(Not Included)

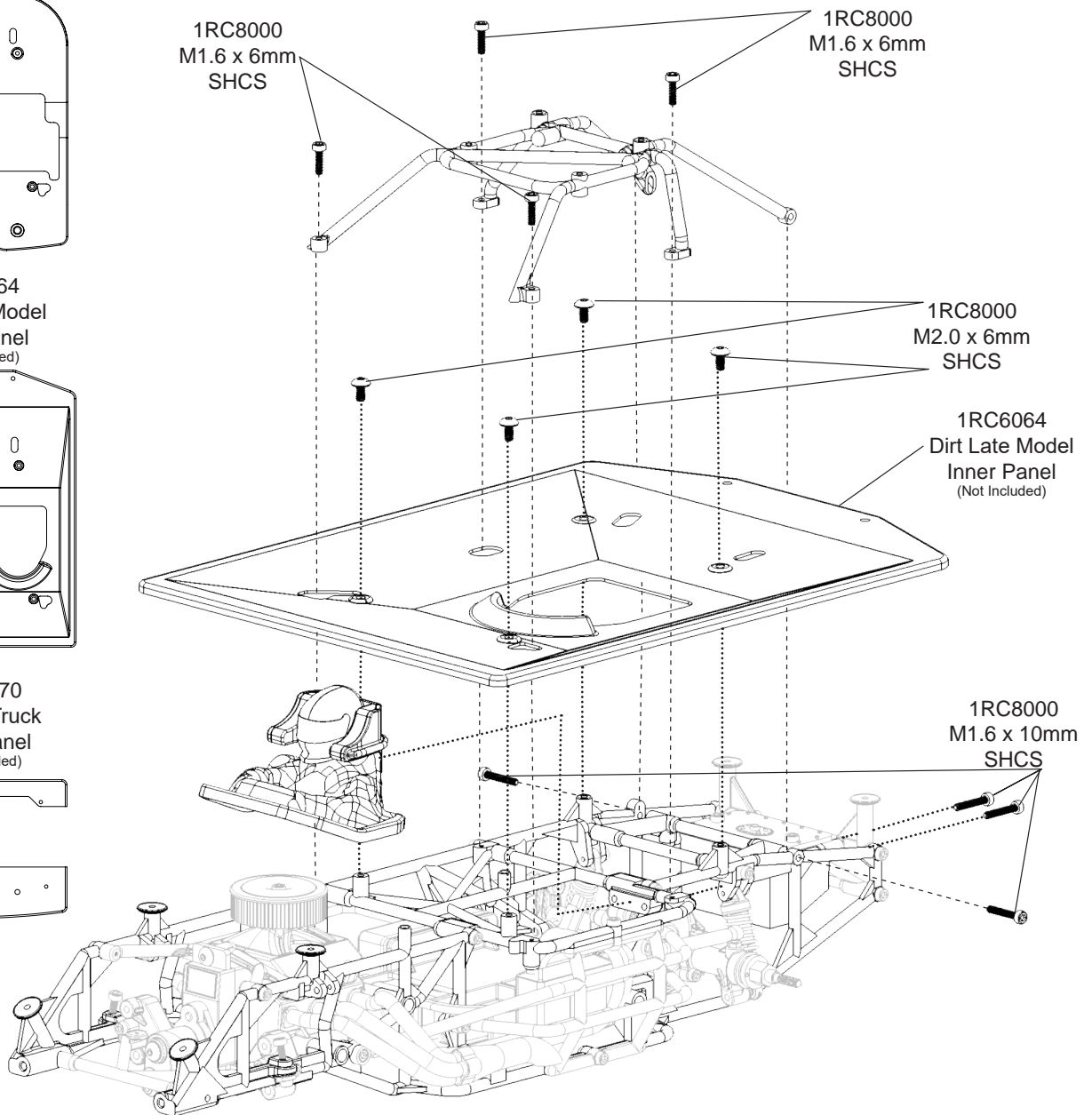
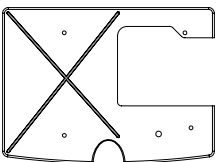

BAG 4 - FINAL ASSEMBLY

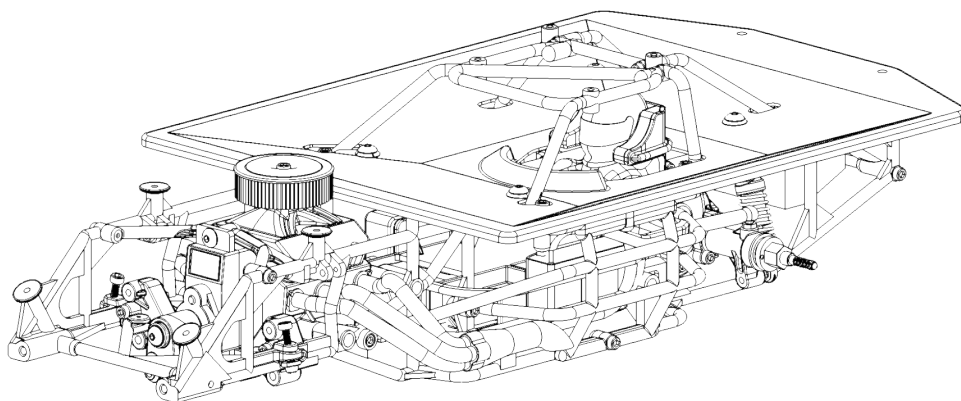

BAG 5 - STEP 1 - FRONT SUSPENSION ARM ASSEMBLY

ASSEMBLY NOTES

- Press the Pivot Balls into Arms by placing the flat end of Pivot Ball on a hard surface and then press plastic Suspension Arm onto Pivot Ball.
- Ensure Pivot Balls are free after installation.

REMINDER

Do not overtighten screws.

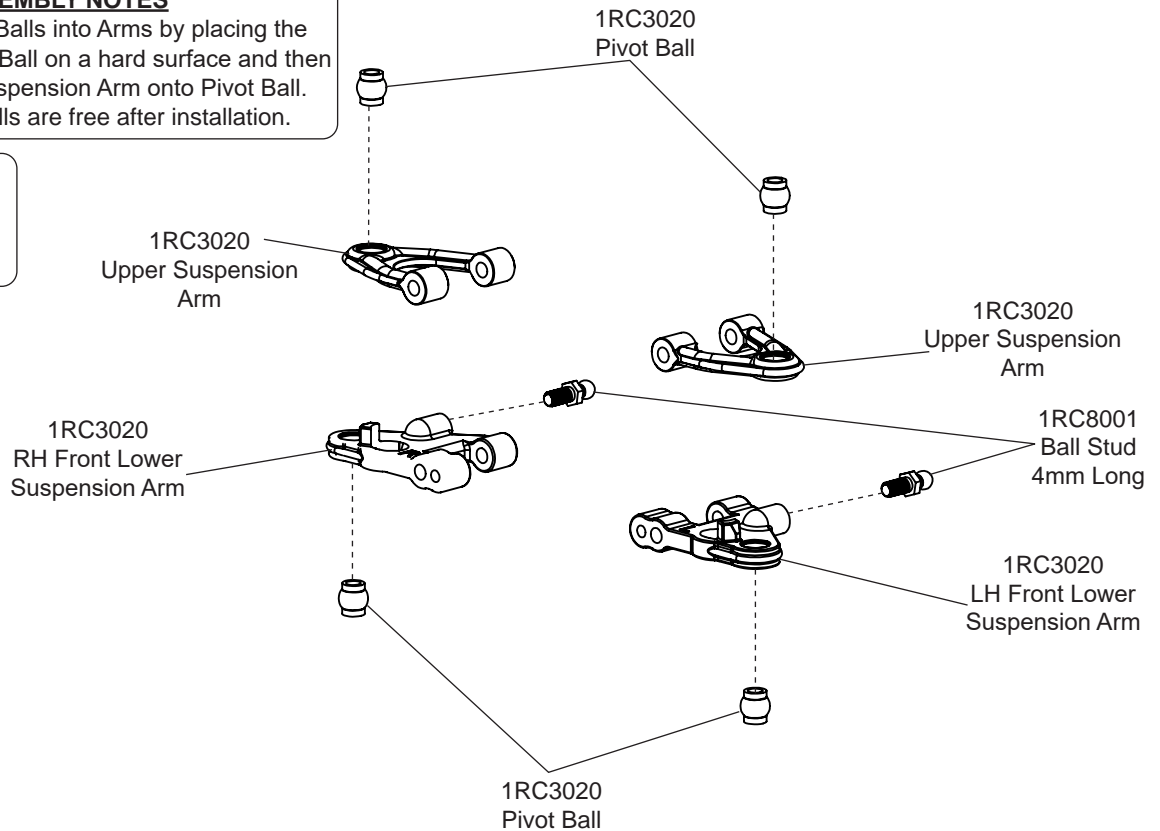

BAG 5 - STEP 2 - FRONT SUSPENSION ARM ASSEMBLY

ASSEMBLY NOTE

Ensure spring sits in cavity of lower suspension arm

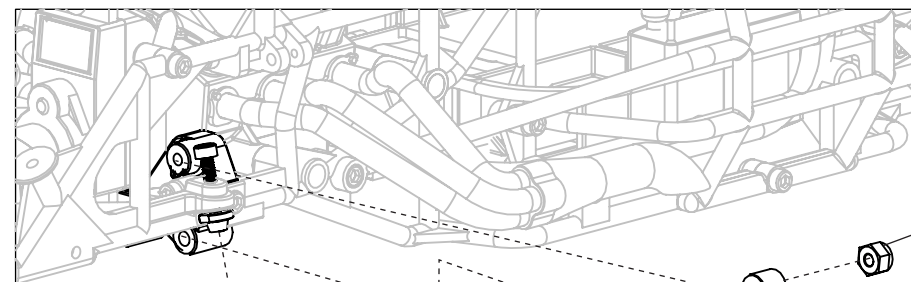
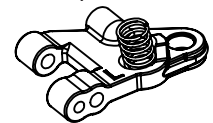

1RC5009
Front Spring
Medium

1RC3021
M2.0 x 20mm
SHCS

1RC3021
M2.0 x 4mm
Truss Head

1RC3021
M2 Washer

1RC3021
Lower Front
Hinge Pin

1RC8000
M2.0 Nylock Nut

Ensure Upper Suspension Arms are installed as shown. Notice how Upper Arm sweeps forward.

Start with caster adjustment as shown with equal space between these two areas.

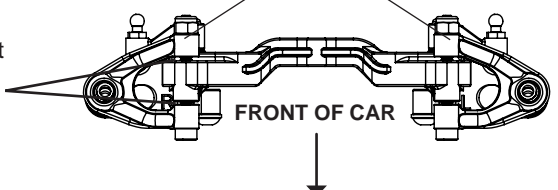

BAG 5 - STEP 3 - STEERING ROD & SPINDLE ASSEMBLY

ASSEMBLY NOTES

- Complete the right front suspension using the details shown in this step.
- After this assembly step is complete, ensure both the left and right suspension operate freely.

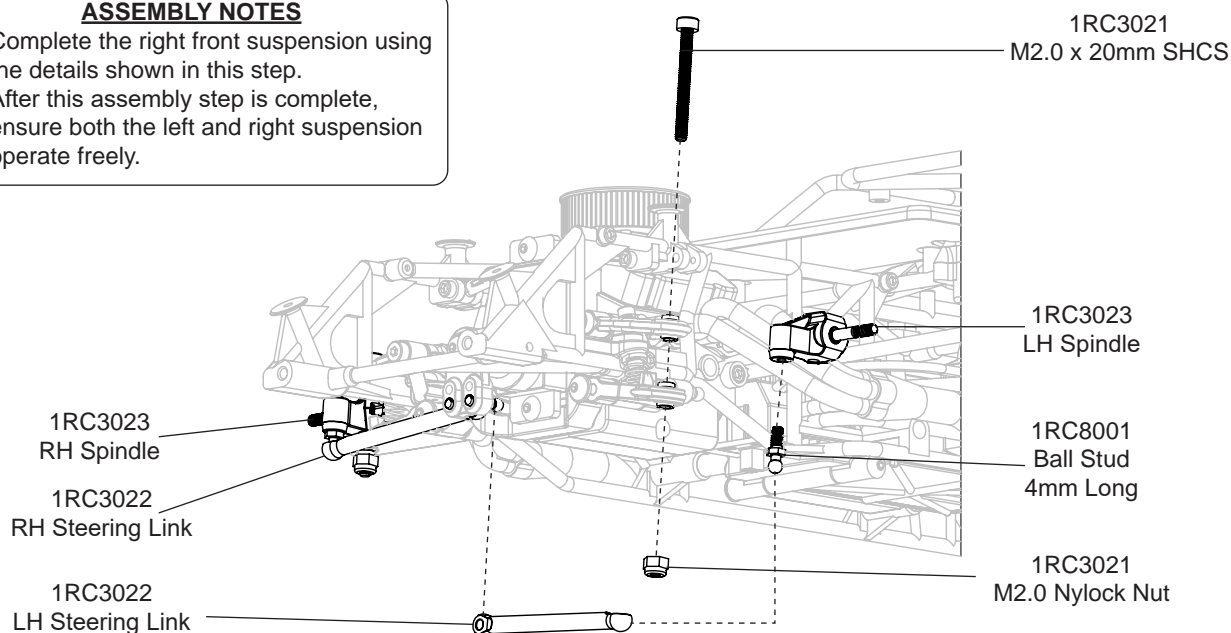

BAG 5 - STEP 4 - FRONT BUMPER ASSEMBLY

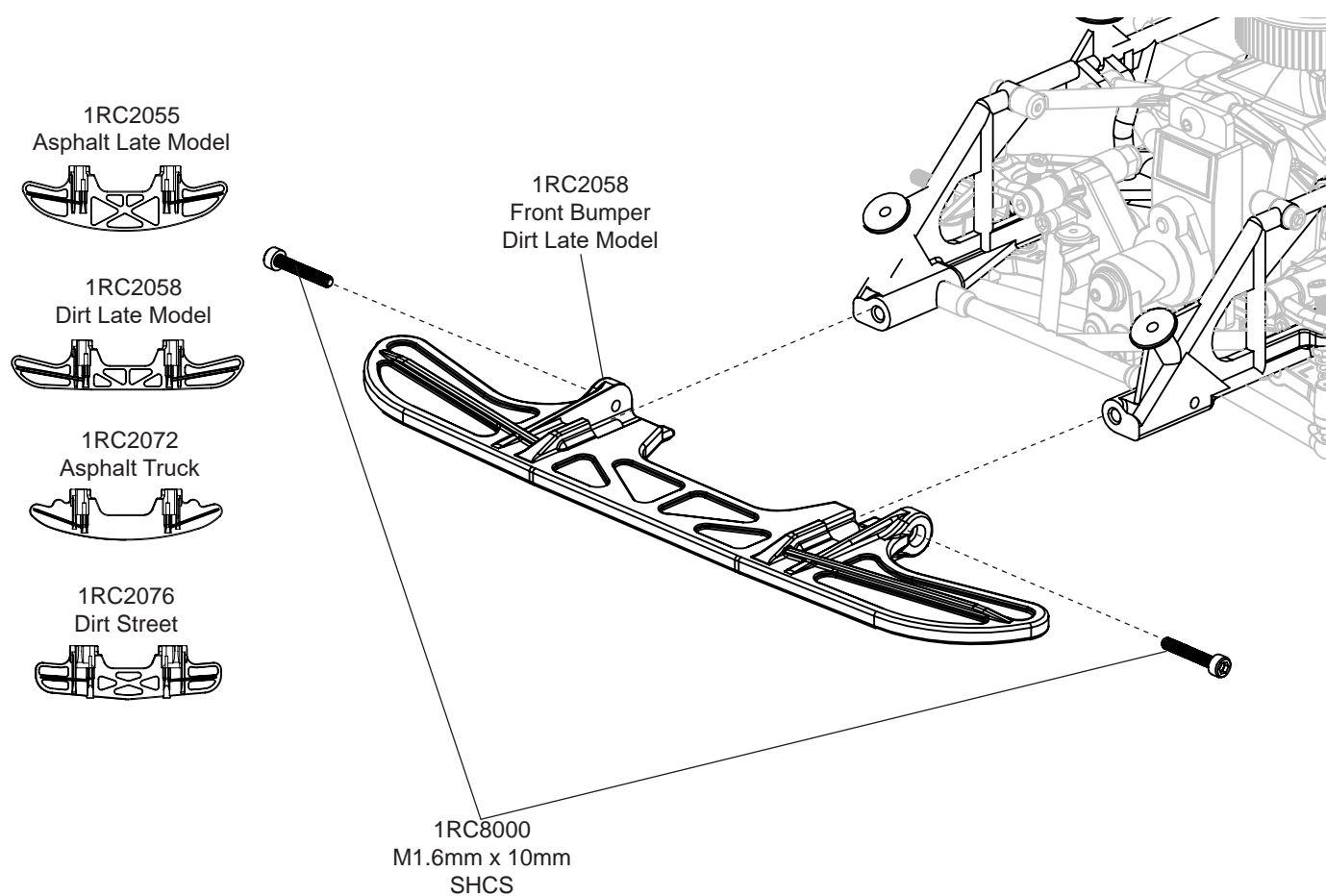

BAG 5 - STEP 5 - FRONT SHOCK INSTALLATION

ASSEMBLY NOTE

Do not overtighten shock screws. Ensure shock moves freely before connecting it to the ball stud.

ASSEMBLY NOTE

Install right shock the same as shown in this assembly step.

1RC8000
M1.6 x 6mm
SHCS

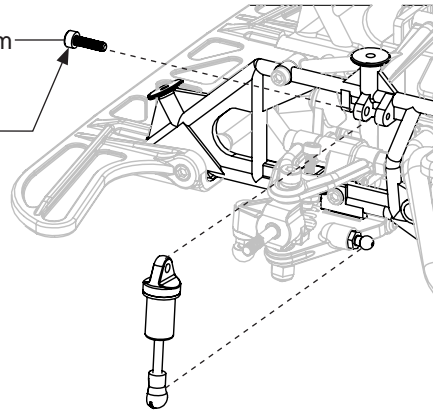

BAG 5 - STEP 6 - WINDOW NET INSTALLATION

ASSEMBLY NOTE

Install M1.6 x 6mm SHCS first followed by M2 x 6mm Truss Head.

1RC2056
Asphalt Late Model

1RC2073
Asphalt Truck

1RC2077
Dirt Street Stock

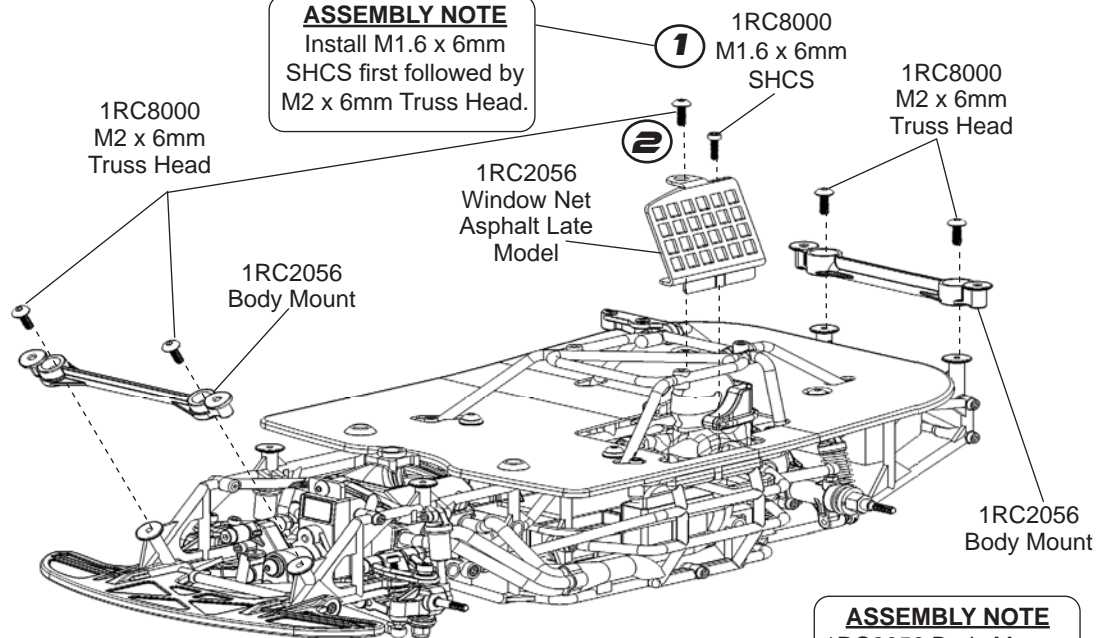

ASSEMBLY NOTE

1RC2056 Body Mounts are only required for Asphalt Late Model

BAG 5 - FINAL ASSEMBLY

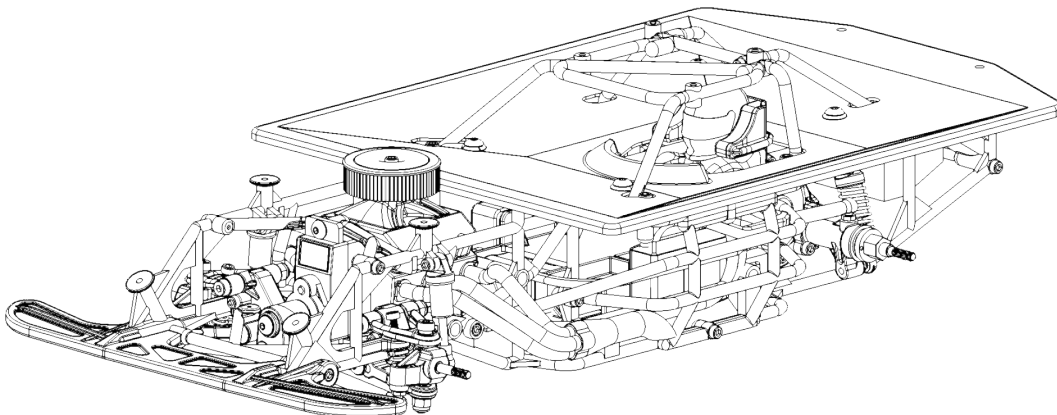

BAG 5 - BODY INSTALLATION

1RC6059
Body Set, Clear,
1/18 Asphalt LM

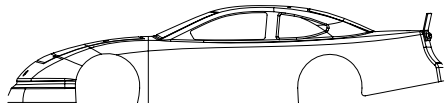

1RC6070
Body & Driver, Clear,
1/18 Asphalt Truck

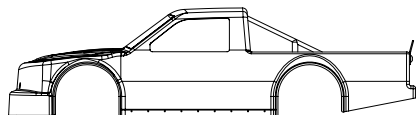

1RC6073
Body & Driver, Clear,
1/18 Dirt Street Stock

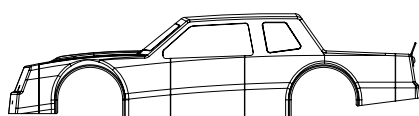

1RC6064
Body Set, Clear,
1/18 Late Model

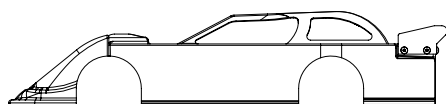

1RC8000
M2.0 x 6mm
SHCS

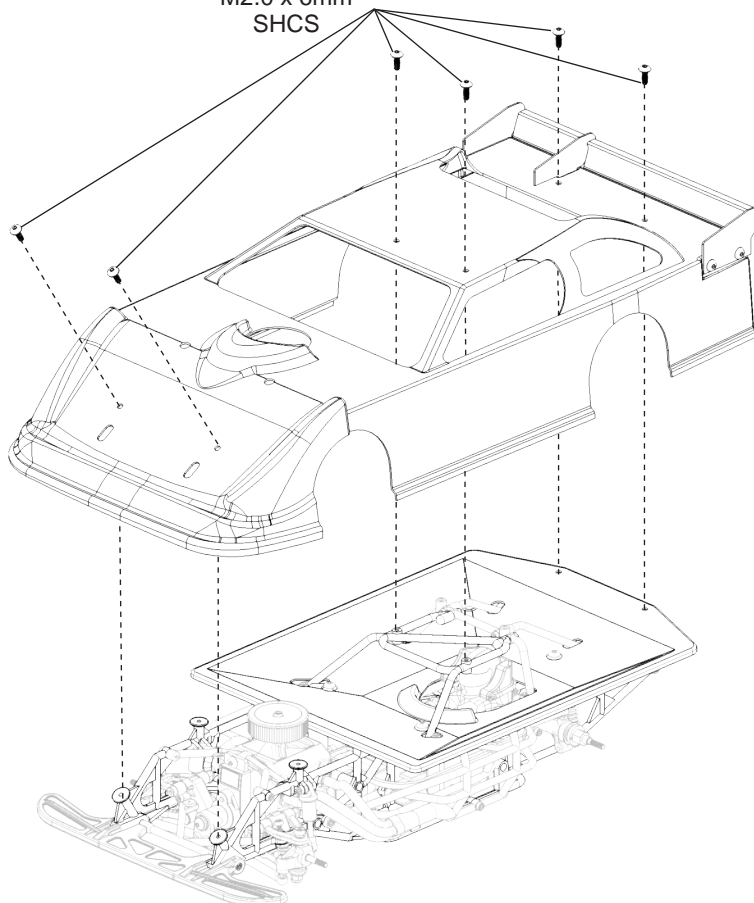

BAG 5 - WHEEL & TIRE INSTALLATION

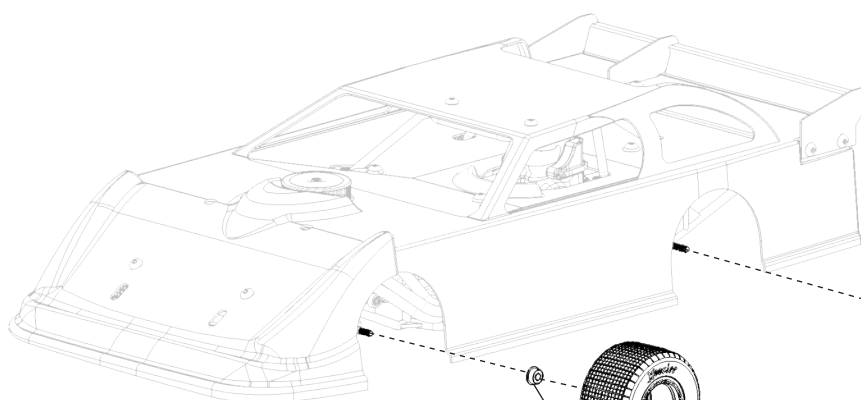

1RC8505
2.0mm x 5.0 x 2.5
Flanged Bearing

1RC8000
M2.0 Nylock Nut

Asphalt Late Model & Truck

1RC5560 FR/RR Tires & Black Wheels Asphalt LM (4)
1RC5561 FR/RR Tires & Chrome Wheels Asphalt LM (4)
1RC5562 FR/RR Soft Tires & Black Wheels Asphalt LM (4)
1RC5563 FR/RR Soft Tires & Chrome Wheels Asphalt LM (4)



Dirt Street Stock

1RC5544 FR/RR Tires & Black Wheels, Modified (4)
1RC5545 FR/RR Tires & Chrome Wheels, Modified (4)
1RC5546 FR/RR Soft Tires & Black Wheels, Modified (4)
1RC5547 FR/RR Soft Tires & Chrome Wheels, Modified (4)



Dirt Late Model

1RC5539 FR/RR Tires & Black Wheels, LM (4)
1RC5540 FR/RR Tires & Chrome Wheels, LM (4)
1RC5541 FR/RR Soft Tires & Black Wheels, LM (4)
1RC5542 FR/RR Soft Tires & Black Wheels, LM (4)

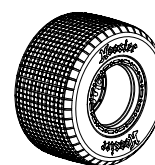

REPLACEMENT PARTS

1RC2032	Frame, 1/18 LM
1RC2034	Engine Parts, 1/18 LM
1RC2037	Frame, 1/18 Modified
1RC2038	Frame Sides Only, 1/18 Modified
1RC2058	Ft. Bumper & Side Nerf Bar, 1/18 LM 2.0
1RC2072	Ft. Bumper, 1/18 Asphalt Truck
1RC2073	Cage Parts, 1/18 Asphalt Truck
1RC2076	Front Bumper, 1/18 Dirt Street Stock
1RC2077	Cage Parts, 1/18 Dirt Street Stock
1RC3000	Rear End , 1/18 Mid, Spr, EDM
1RC3020	Front Suspension Plastics Set, 1/18 LM
1RC3021	Front Suspension Hardware Set, 1/18 LM
1RC3022	Radius Rods, 1/18 LM
1RC3023	Front Spindles, 1/18 LM

1RC4001	Rear Axle & Compound Gear, 1/18 Spr, EDM
1RC5000	Shock Set, 1/18 Mid, Spr, EDM (4)
1RC5004	Shock Plastic Pars, 1/18 Mid, Spr, EDM
1RC5009	Spring Set, Front, 1/18 LM
1RC5011	O-Rings, Clear, Shocks, 1/18 LM (10)
1RC7009	Heatsink, Motor, 1/18 Mid, Spr, EDM
1RC7015	Double Stick Tape, ESC & Rx, 1/18th
1RC7025	Servo/ESC Extension Wire, 100mm, 1/18 Scale
1RC8000	Hardware Set, 1/18 Mid, Spr, EDM, LM
1RC8001	Ball Stud & Pivot Ball Set, 1/8 Mid, Spr, EDM
1RC8002	Roll Pin Set, 1/18 Mid, Spr, EDM (8)
1RC8503	Bearing Set, 1/18 Mid, Spr, EDM (8)
1RC8505	Flanged Bearing Set

OPTION PARTS

1RC2033	Frame Sides Only, 1/18 LM
1RC3013	Rear End, Black, 1/18 Mid, Spr, EDM
1RC3024	Adjustable Front Tie Rod, 1/18 LM
1RC3025	Servo Arm, Solid, 21T, 1/18 LM

1RC4003	Offset Wheel Hexes, 1/18 Mid, Spr, EDM
1RC4016	HD Rear Axle & Compound Gear, 1/18 LM
1RC5001	Spring Kit, 1/18 Mid, Spr, EDM
1RC8005	Self Threading Screws, M1.6 x 10mm (20)

BODIES

1RC6020	Driver Figure, Clear, 1/18
1RC6059	Body Set Clear, 1/18 Asphalt Late Model
1RC6064	Body Set, Clear, 1/18 LM 2.0

1RC6070	Body & Driver, Clear, 1/18 Asphalt Truck
1RC6073	Body & Driver, Clear, 1/18 Dirt Street Stock

ELECTRONICS

1RC7003	8700Kv Brushless Motor & 10T Pinion
1RC7007	NiMH Battery, 5Cell NiMh, 6.0V, 230mAh
1RC7011	10000Kv Brushless Motor & 10T Pinion
1RC7012	Transmitter & Receiver, GT2E

1RC7014	ESC Only, 1/18 Scale
1RC7017	Steering Servo, Digital Metal Gear, 18th Scale
1RC7020	Steering Servo, 1/18 LM

TIRES

1RC5539	FR/RR Tires & Black Wheels, 1/18 LM (4)
1RC5540	FR/RR Tires & Chrome Wheels, 1/18 LM (4)
1RC5541	FR/RR Soft Tires & Black Wheels, 1/18 LM (4)
1RC5542	FR/RR Soft Tires & Chrome Wheels, 1/18 LM (4)
1RC5544	FR/RR Tires & Black Wheels, 1/18 Modified (4)
1RC5545	FR/RR Tires & Chrome Wheels, 1/18 Modified (4)

1RC5546	FR/RR Soft Tires & Black Wheels, 1/18 Modified (4)
1RC5547	FR/RR Soft Tires & Chrome Wheels, 1/18 Modified (4)
1RC5560	FR/RR Tires & Black Wheels, 1/18 ALM (4)
1RC5561	FR/RR Tires & Chrome Wheels, 1/18 ALM (4)
1RC5562	FR/RR Soft Tires & Black Wheels, 1/18 ALM (4)
1RC5563	FR/RR Soft Tires & Chrome Wheels, 1/18 ALM (4)

TOOLS

1RC8801	1.5mm Hex Driver, Mini Handle, Black
1RC8802	3.0mm Hex Socket Driver, Mini Handle, Black
1RC8803	4.0mm Hex Socket Driver, Mini Handle, Black
1RC8810	1.5mm Hex Driver, Long, Mini Handle, Black

1RC8821	Shock Assembly Tool
1RC8822	Pit Tray, Gray
1RC8830	Diagonal Flush Cut Pliers

Limited Warranty and Service Contact Information

Limited Warranty

1 RC Racing, LLC warrants the model and its components to be free of defects in material and workmanship at the date of purchase to the original purchaser, warranty is not transferable.

Limitation of Liability

1 RC RACING, LLC SHALL NOT BE LIABLE FOR SPECIAL, INDIRECT, INCIDENTAL OR CONSEQUENTIAL DAMAGES, LOSS OF PROFITS OR PRODUCTION OR COMMERCIAL LOSS IN ANY WAY, REGARDLESS OF WHETHER SUCH CLAIM IS BASED IN CONTRACT, WARRANTY, TORT, NEGLIGENCE, STRICT LIABILITY OR ANY OTHER THEORY OF LIABILITY, EVEN IF 1 RC RACING, LLC HAS BEEN ADVISED OF THE POSSIBILITY OF SUCH DAMAGES.

Service Contact Information

All service/warranty requests should be sent to support@1RC-Racing.com and should contain the following information.

1. Name and shipping address and contact info
2. Picture of part(s) in question
3. Description of running condition when part broke

All warranties will be reviewed and an email will be sent back within 2-5 days with details of the warranty.

TUNING TIPS

Oversteer - A handling condition where a vehicle's rear tires lose traction and the car turns more than the driver intends, causing the car to slide or spin out through the turn.

Car Loose (Oversteer) on Corner Entry

1. Reduce Dual Rate on the Transmitter.
2. Add spring shims to right front shock.
3. Use stiffer spring on right front shock.
4. Reduce caster in right front.
5. Use harder compound right front tire.
6. Add super glue to outer edge and sidewall of right front tire. Ensure super glue is completely dry before running.

Car Loose (Oversteer) on Corner Exit

1. Reduce Dual Rate on the Transmitter.
2. Add spring shims to left rear shock.
3. Use stiffer spring on left rear shock.
4. Reduce left front caster.
5. Use softer compound left rear tire.

Understeer - A handling condition where a vehicle's front tires lose grip and the car turns less than the driver intends, causing the car to push wide through the turn.

Car Tight (Understeer) on Corner Entry

1. Increase Dual Rate on the Transmitter.
2. Add spring shims to left front shock.
3. Use stiffer spring on left front shock.
4. Increase right front caster.
5. Use softer compound right front tire.
6. Use wider rear wheel hex (1RC4003) on right rear.
7. Use narrower rear wheel hex on left rear.

Car Tight (Understeer) on Corner Exit

1. Increase Dual Rate on the Transmitter.
2. Add spring shim to right rear shock.
3. Use stiffer spring on right rear shock.
4. Increase left front caster.
5. Use softer compound right rear tire.
6. Use wider rear wheel hex (1RC4003) on right rear.
7. Use shorter rear wheel hex on left rear.

Car Hopping (Rear Tires Bouncing/Chattering) through the Corner

1. Remove all four shocks and ensure suspension moves up and down freely.
2. Ensure all radius rods are free.
3. Make sure shock O-rings are lubed and the shocks move freely.
4. Add super glue to outer edge and sidewall of right front tire. Ensure super glue is completely dry before running.



GENERAL SETUP SHEET

☐ 1/18 ASPHALT LATE MODEL

☐ 1/18 DIRT LATE MODEL

☐ 1/18 ASPHALT TRUCK

☐ 1/18 DIRT STREET STOCK

Driver : _____ Date: _____

Track Name: _____ City/State: _____

Surface: _____ ☐ Indoor ☐ Outdoor (check one)

Race: _____ Start: _____ Finish: _____

LEFT FRONT

Tire Compound: ☐ Std ☐ Soft

Shock O-Ring: ☐ Yes ☐ No

Shock Type: ☐ Plastic ☐ Aluminum

Oil/Grease: _____

Spring: ☐ Soft ☐ Med ☐ Hard

Spring Preload: _____

Caster: _____

Corner Weight: _____

Chassis Height: _____

FRONT

Toe: _____

Caster: _____

Total Car Weight: _____

RIGHT FRONT

Tire Compound: ☐ Std ☐ Soft

Shock O-Ring: ☐ Yes ☐ No

Shock Type: ☐ Plastic ☐ Aluminum

Oil/Grease: _____

Spring: ☐ Soft ☐ Med ☐ Hard

Spring Preload: _____

Caster: _____

Corner Weight: _____

Chassis Height: _____

ELECTRONICS

Servo: _____

ESC: _____

Tx: _____

Rx: _____

Battery: ☐ 4-Cell ☐ 5-Cell ☐ Other

Motor: ☐ 8700kv ☐ 10,000kv

MISC.

Servo Arm Hole:

☐ Upper

☐ Lower



Dual Rate Amount: _____

Motor Heatsink: ☐ Yes ☐ No

Other: _____

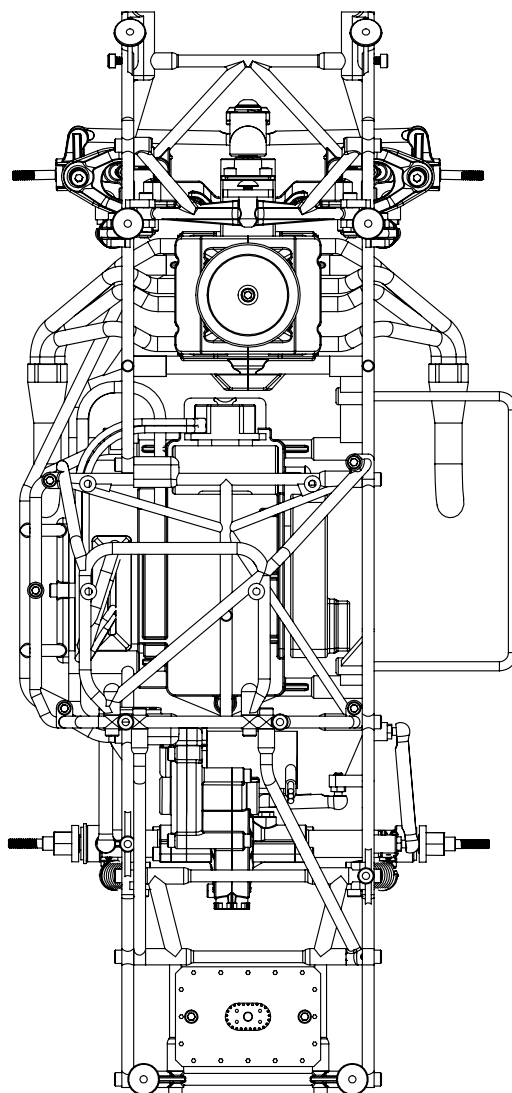

LEFT REAR

Tire Compound: ☐ Std ☐ Soft

Shock O-Ring: ☐ Yes ☐ No

Shock Type: ☐ Plastic ☐ Aluminum

Oil/Grease: _____

Spring: ☐ Soft ☐ Med ☐ Hard

Spring Preload: _____

Caster: _____

Corner Weight: _____

Chassis Height: _____

REAR

Other: _____

RIGHT REAR

Tire Compound: ☐ Std ☐ Soft

Shock O-Ring: ☐ Yes ☐ No

Shock Type: ☐ Plastic ☐ Aluminum

Oil/Grease: _____

Spring: ☐ Soft ☐ Med ☐ Hard

Spring Preload: _____

Caster: _____

Corner Weight: _____

Chassis Height: _____

NOTES:



RACING, LLC

WWW.1RC-RACING.COM

